

Data Sheet

23DDG MiniGauge

FEATURES

- Case/socket enclosure prevents dust, water, and corrosion
- Direct Drive Technology for excellent shock resistance
- Silicone-dampened coil (option) resists vibration effects

TYPICAL USES

- Air inflators/compressors
- Mini FRL's
- Pneumatic stack valves
- Medical/dental equipment
- Specialized OEM equipment



23DDG
0.906" (23 mm) dial size



SPECIFICATIONS

| | |
|------------------------------|---|
| Accuracy: | ±5% of span at setpoint |
| Size: | 0.906" (23 mm) |
| Repeatability: | Better than 1% |
| Range: | 180° arc: 60 - 100 psi 235° arc: 160 - 300 psi |
| Process Connection Location: | Back |
| Process Connection Size: | 1/8" NPT |
| Dial: | Black figures on white background, aluminum |
| Pointer: | Brass, painted black |
| Dampening options: | Silicone dampened tube |

WETTED COMPONENTS

| | |
|------------------|--------------------|
| Coil | Process Connection |
| Beryllium copper | Brass |

NON-WETTED COMPONENTS

| | |
|-------------------|---------------|
| Case | Window |
| ABS blend (black) | Polycarbonate |

MIN/MAX TEMPERATURE LIMITS

| Version | Ambient | Process | Storage |
|---------|-----------------------------------|-----------------------------------|-----------------------------------|
| 23DDG | -40°F to 150°F (-40°C to 65°C) | -40°F to 150°F (-40°C to 65°C) | -40°F to 150°F (-40°C to 65°C) |

KEY BENEFITS

- High impact-resistant polycarbonate window
- Reliability under rugged operating conditions
- ABS case material that is enduring and attractive
- Easy installations using wrench flats
- Cost effective solution
- Customizable dials
- No gears or bearing to wear out

Data Sheet

23DDG MiniGauge

| ORDERING CODE | Example: | 23DDG | 01 | B | 100 | S50 | XT5 |
|---|----------|-------|----|---|-----|-----|-----------|
| Model/Dial Size | | | | | | | |
| 23DDG - 0.906- inch (23mm) Black, ABS blend case | | 23DDG | | | | | |
| Process Connection Size | | | | | | | |
| 01 - 1/8 NPT Male | | | 01 | | | | |
| KG - 1/8 BSPT; R 1/8 84-PT 1/8 | | | | | | | |
| Process Connection Location | | | | | | | |
| B - Back | | | | B | | | |
| Range (coding example only, see range table below for all standard ranges) | | | | | | | |
| Single Scale | | | | | | | |
| 100 - 100 psi | | | | | 100 | | |
| Setpoint | | | | | | | |
| S50 - 50 psi | | | | | | S50 | |
| Options (If choosing an option(s) must include an "X") | | | | | | | |
| T5 - Throttle plug 0.013" | | | | | | | X__ T5 |
| T7 - Throttle plug 0.020" | | | | | | | |
| T9 - Throttle plug 0.063" | | | | | | | |
| SF - Silicone dampened tube for vibration | | | | | | | |
| RS - RoHS (EN directives 2011/65/EN and 2015/863) | | | | | | | |

RANGE TABLE

| RANGE | RANGE CODE |
|----------|------------|
| 0/60psi | 60S30 |
| 0/100psi | 100S50 |
| 0/160psi | 160S80 |
| 0/200psi | 200S100 |
| 0/300psi | 300S150 |

DIMENSIONS in [] are millimeters

For reference only, consult Ashcroft for specific dimensional drawings

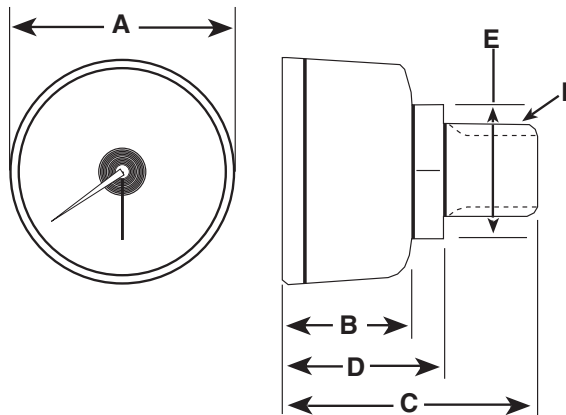

| Back Connection | | | | | | | Weight oz / kg |
|-----------------------|--------------|--------------|--------------|--------------|--------------|---------|----------------------|
| Dial Size Inches | A | B | C | D | E | F | |
| 0.906" [23] | 0.90 [23] | 0.55 [14] | 1.07 [27] | 0.67 [17] | 0.56 [15] | 1/8 NPT | 0.564 oz 0.016 kg |